

Thomas J. Watson Library of Business & Economics First Floor: Reading Room and Circulation Area

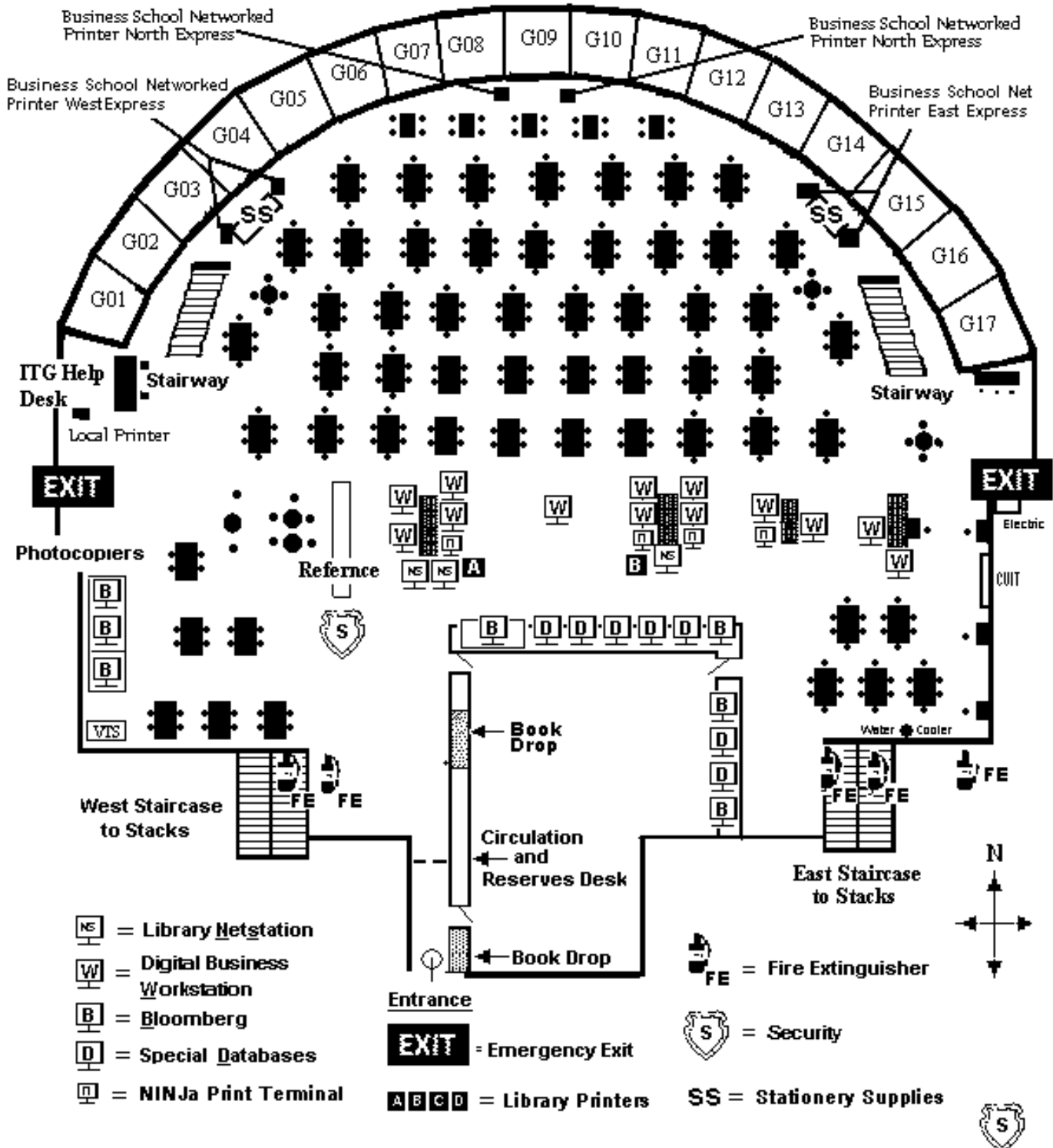

- Network jacks and electrical outlets are located along the northern perimeter and around each column in the reading room and on the second and third floors.
- Wireless connectivity is available from the tables in the center of the reading room
- Printing via the "Ninia" system is available from all terminals in the reading room.



Thomas J. Watson Library of Business & Economics

First and Second Mezzanine

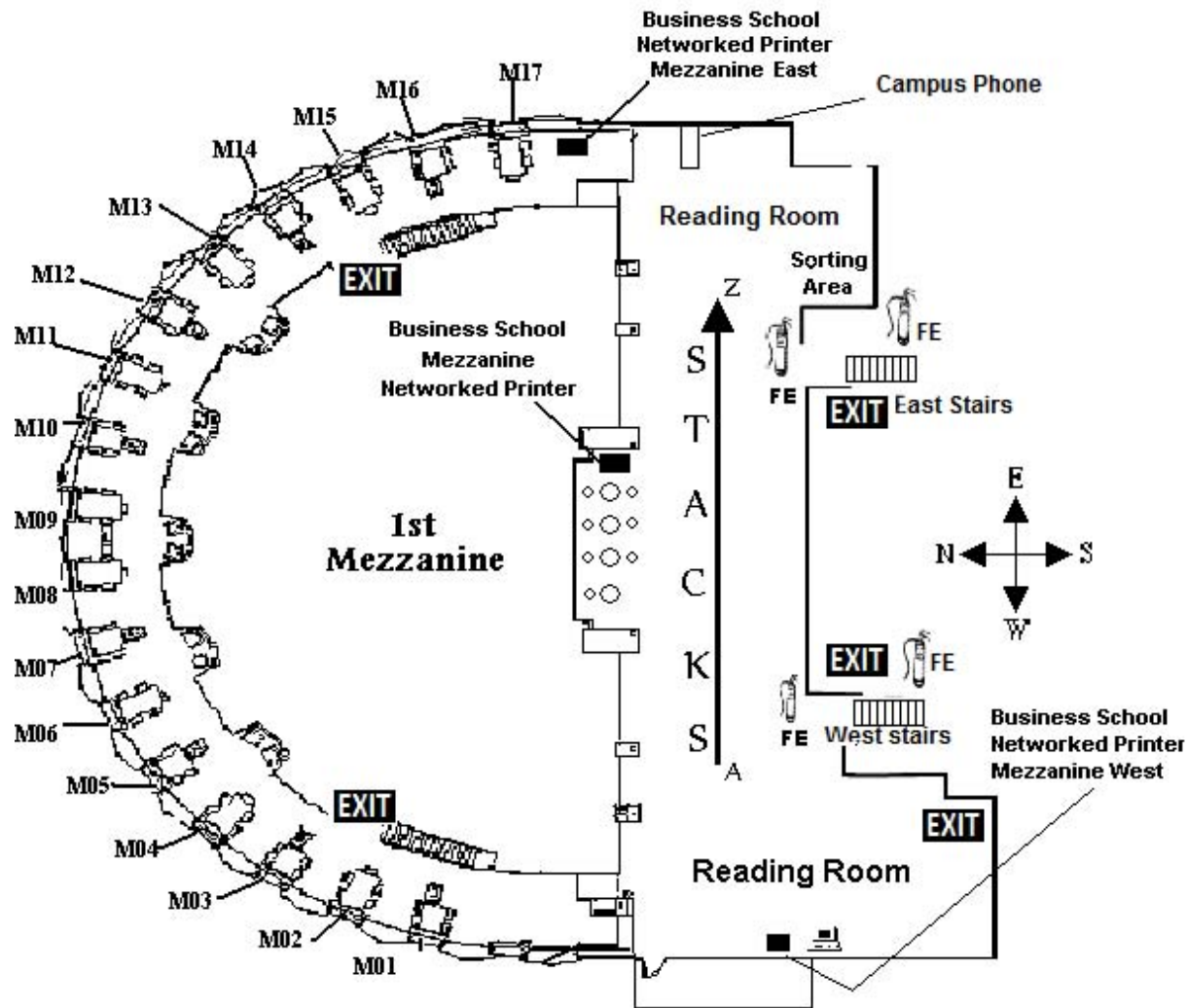
First Mezzanine



Reference and Reserve books are located on the main floor of the library

-  = Library Netstation
- EXIT** = Emergency Exit
-  = FE-Fire Extinguisher

Second Mezzanine

